



Rhydd Covert

Scout Camp Site and Activity Centre



WELCOME TO RHYDD COVERT SCOUT CAMPSITE & ACTIVITY CENTRE

This Brochure is designed to provide you with the essential information needed for planning of your camp & activity programme. You can also find more information & latest news on our Website – www.rhyddcovert.org.uk

The Site – Rhydd Covert is owned and run by Kidderminster District Scout Council.

The site is set in 50 acres of unspoilt woodland and grassland areas, which fall naturally into individual sites of varying sizes. Each site has a central grassed area surrounded by trees & undergrowth affording a certain amount of privacy and generally shielding campsites from each other. All sites are within easy reach of a water supply.

Ebury Rise is a large tiered field and is particularly useful for larger camps, events & activities

Rhydd Covert has areas of sandstone rock, heather & fern and is home to squirrels, rabbits, various birds and other animals. *We also hear strange noises from our neighbours in the Safari Park!*

Our History – In June 1977 the family of Major & Mrs Harcourt-Webb donated the woodland, which forms the main area of the campsite, to Kidderminster Scouts in memory of the couple & their son. However it had been used by scouts as a meeting place, training facility & camp ground since the early 1940s.

In 1983 the land, which now forms sites 12, 13, 14 & 15, was bought from a neighbour and then in 1994 the large field near the entrance, now known as Ebury Rise, was added.

Most recently, following an arson attack in 2004 which destroyed its “Nissen Hut” predecessor, our local newspaper launched a public appeal entitled “Operation Covert” to raise funds to replace the facility. We opened our “Activity Centre” in summer 2006.

WARDEN & SERVICE TEAM

The **Warden & Service Team Members** are all volunteers. During the winter there may only be someone “on-duty” on-site at certain times during the weekend. From the end of March to the end of August there will be someone “resident - on duty” for the weekend.

Working Parties – Each year we will organise service days for Leaders & Young People to come along & take part in maintenance projects around the site, if groups would like to take part in one of these (or would like to undertake another specific project) please speak to the Warden.

SITE RULES

Uniform – As Rhydd Covert is a Scout Campsite uniform is to be worn on arrival and departure.

On Arrival – The site has a one-way system in operation – all drivers are asked to follow this and keep to the site speed limit of 5mph. Designated parking places are available at each site, please ensure that all other vehicles once unloaded are parked in the main car park. Please ensure that all gates & access routes to are kept clear at all times.

Ground Fires – On designated sites only.

Altar Fires – The site has a quantity of altar fires available for campers – these should be used on non-grassed areas or at the edge of grassed areas only.

Camp Ovens – Certain backwoods fires can be built & used in designated areas of the site, prior booking with the Warden is advised.

Wet Pits – Above ground types only permitted – No holes to be dug or turf to be cut.

Trees – No timber of any description to be cut down without the express permission of the Warden.

Axes & saws – Are only to be used in designated chopping areas and must not be taken off sites.

Lights Out – At 11pm – Please ensure that noise is kept to a minimum after this time.

Dogs – Campers & visitors may bring dogs only on the understanding that they are kept under control at all times – any “fouling” by dogs must be removed.

Accidents – All accidents must be reported to the Warden or a member of the Service Team.

Fire Equipment – Groups should bring with them (& make available to everyone on their site) suitable & sufficient fire safety equipment, that is felt necessary for the type of camp & number of participants.

Registered Youth Organisations – Other Registered Youth Organisations are allowed to use the site at the discretion of the site Warden.

Recycling – we have containers on site for collecting glass (jars & bottles), plastics & cans for recycling – these are located in the service team area. Please ensure that all items deposited for recycling have been washed & that cans are “un-burnt” & preferably squashed.

Waste Disposal – Campers are encouraged to burn all their rubbish. All ashes to be placed in the skip provided which is in the service team area (no embers).

On Departure – Your site/s will be inspected before your departure, please leave the site/s as you would wish to find them. All unused wood must be returned to the woodpile & altar fires to the designated area. Deposits will be returned when the Duty Warden has inspected (and is happy with) your site.

ACTIVITIES

At Rhydd Covert we are working in partnership with ACTIVATE, a local Scout and Guide Fellowship who specialise in a wide variety of adventurous activities – through them we are able to provide Instructors for the activities such as Archery, Rifle Shooting, Climbing & Abseiling which we offer on-site at Rhydd, as well as other activities off-site too.

All Instructors provided by Rhydd/Activate to supervise or lead an adventurous activity session for “Groups” will hold the appropriate qualification for the booked activity as required in PO&R. They are also all volunteers with limited availability.

Groups who wish to use their own instructors to run an activity session must provide proof of their qualifications to the Warden or Activate representative prior to the session taking place.

Archery – The sites’ Archery Range complies with all the rules & regulations of the Scout & Guide Associations. We have our own equipment, which is suitable for all age groups.

Rifle Shooting – Our Shooting Range complies with all the rules & regulations of the Scout & Guide Associations. We have our own equipment and do not encourage Groups to bring their own guns onto the site.

Climbing Wall & Abseil Tower – Our tower stands 42 foot high in its own compound. The climbing wall has is fitted with colour coded routes to suit all abilities.

Crate Stacking – How high can you build a stack of milk crates whilst stood on top? 10 – 20 – 30 crates high? Only your nerve and balance will decide.

Grass Sledging – Have fun Tobogganing on our special sledges down Ebury Rise.

Assault Course – The basic elements of this activity are permanently set up an area of woods on the site – additional elements ~ nets, ladders, ropes, etc, ~ will be added to this when the course is booked.

Orienteering – A permanently marked course is laid out on the site and maps are available from the Warden, a member of the Service Team or the Shop during opening hours.

Pioneering – A quantity of poles are available - please ask the Warden or a member of the Service Team.

Bivouacking – Welcome at anytime of the year but nothing to be cut down except for ferns. Please ensure that bivouacs are properly dismantled and disposed of.

Rhydd Cat Trail – An after dark activity popular with younger sections, using torches to follow the trail around the site. How many can you find?

Other Activities

On-Site – Giant Draughts, Waterslide, Crafts, Games Equipment for Indoor & Outdoor Games.

Off-Site – we can offer via Activate – Canoeing, Kayaking, Rowing, Sailing, Power Boating, Narrow boating, Rock Climbing & Mountain Biking. Visit their website - www.activateteam.org.uk

Instructors – Please note that all of our activity instructors are volunteers. All activities are subject to weather conditions, if the instructor declares the weather to be unsuitable for your activity we will try to re-schedule as best we can.

Misbehaviour – during any activity will not be tolerated and the Instructor has the right to withhold instruction to the Group. It is the Groups responsibility to supervise & occupy young people who are not actively involved in the "booked" activity.

FACILITIES

Activity Centre - A modern building with lots of floor space, a good sized central hall & a number of smaller rooms off. It has a fully equipped kitchen & its own toilet facilities. This building comes with an adjacent grassed area (immediately outside the main doors) ideal for a smaller camp with a seating area and trees providing shelter for those outdoor activities. Sites five and three are close by if required.

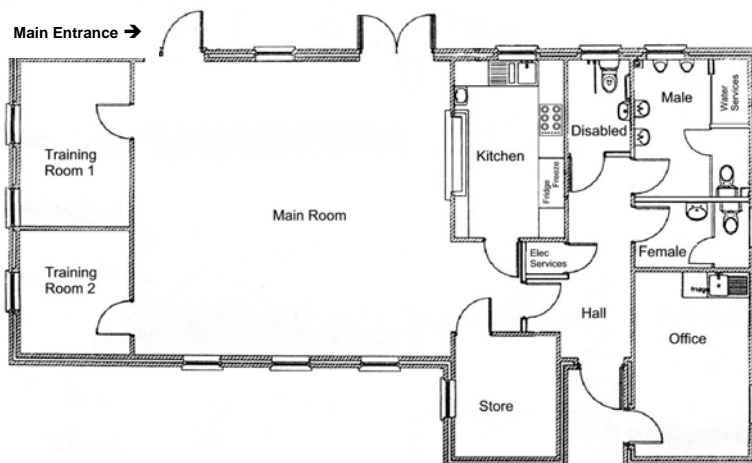

Toilet & Shower Blocks – Ladies & Gents, situated centrally on the site with hot & cold running water. Limited services during the winter period.

Recreation Area – A large open flat(ish) area suitable for events – has power, lighting & a flagpole.

Water – There is a mains water supply to points all over the site during the “High” season with a restricted service during the winter months.

Woodpile – A good supply of fallen timber is always available on site as well as a well-stocked woodpile.

Camp Shop – Well stocked with – Badges, Uniform, Souvenirs, Gifts, “Tuck”, etc.
Opening times –

Summer (April to October) ~

Saturday 10am to 2pm & Sundays 11.30am to 12.30

Winter (November to March)

Saturday 10am to 12md

For more information about the shop contact Hilary Dovey on 01562 744398.

Recycling – Waste Disposal – Facilities are provided both for use on your camp site and within the Service area. Please see ‘Site Rules’ for details.

SITES

Site 1. Stormy Peak. Sheltered woodland site near the entrance to Rhydd Covert. A quiet site close to Archery Range and Ebury Rise.

Site 2. Lower Stormy Peak. Near the entrance to Rhydd Covert. This site is a smaller site close to but detached from Site 1.

Site 3. Central Point. Large site right in the heart of Rhydd Covert. Very close to all amenities.

Site 4. Camp Fire Site. Medium to Large site that slopes up alongside the Camp Fire Circle. This site is very central.

Site 5. Bog Site. Medium to Large site. Situated close to the toilet and shower facilities and opposite the recreation ground and shop.

Site 6. Chapel Site. Large open site surrounded by trees with a gentle slope. Opposite the activity centre.

Site 7. Shady Birches. Medium sized site, surrounded by trees with a number of Silver Birch trees on the site itself.

Site 8. Silver Bank. Medium site, sloping, long and narrow. Running alongside the track to our upper sites.

Site 9. The Grove. Small quiet and compact site. Ideal as an overflow for site 10 or for a large patrol camp.

Site 10. Windy Ridge. Large site. Flat with just the one far end dipping into a slope. A quiet site, out of the way.

Site 11. Safari View. A very quiet site, tap is fairly handy. Very handy for exploring the nature reserve.

Site 12. Tip Top Meadow. Medium to small site. Quiet and out of the way, close to tap. Can be joined with Site 13 for a larger camp.

Site 13. High Oaks. A Smaller site close to the tap, away from the centre of activities. Can be joined with site 12 to make a larger site.

Site 14. Chestnut Levels. A medium to large site with a tap almost on site. Ideal quiet out of the way site. Can be joined with site 15.

Site 15. Range View. A medium to large site adjoining the Rifle Range. Ideal quiet out of the way site. Can be joined with site 14.

Ebury Rise. This is a very large semi terraced site on the entrance to Rhydd Covert. It has it's own Camp Fire Circle & tap.

GENERAL INFORMATION

Lost Property – Please “hand in” any property you find, and report any property you loose, to the Service Team. After 2 months any unclaimed property may be disposed of or sold & any proceeds placed into Rhydd Covert funds.

Site Security – Groups are strongly advised to ensure that someone remains on their campsite at all times to ensure the security of their equipment.

Fridge Freezers – A quantity of Fridge Freezers are available to store food during your stay, we would suggest that bookings are made in advance with the Warden

Planning ahead – Organisers of camps or events, large or small, are welcome to visit the site to discuss their requirements with the Warden or a member of the Service Team. A call in advance of your visit is appreciated as the team are volunteers and only on site at certain times.

PLACES TO VISIT

West Midland Safari Park – Tel – 01299 402114

Severn Valley Railway – Tel – 01299 403816

Bewdley (Historic Town) Museum – Tel – 01299 403573

Wyre Forest Visitors Centre – Tel – 01299 266944

Wyre Forest Glades Leisure Centre – Tel – 01562 515151

Rifle Range Nature Reserve – Managed by Worcestershire Conservation Trust

The Worcestershire Way – access from Blackstone Picnic area, Bewdley.

Tourist Information Centre – Bewdley. Tel – 01299 404740

LOCAL INFORMATION

Places of Worship – Churches for most faiths are located either in Kidderminster or Bewdley. We have a small open-air chapel on-site for your own services & also a quite area available for your use.

Hospitals – the nearest is **Kidderminster Hospital** which has a **Minor Injuries Unit** only – located on the A456 in Kidderminster – on the right just after the traffic lights at the junction with the A4535 (Sutton Rd). Tel – **01562 823424**.

The nearest **Accident & Emergency Dept.** is at **Worcester Royal Hospital** – follow the signs for Worcester on the A449, the hospital is well signposted. Tel – **01905 763333**

Doctors – the nearest Doctors Surgery to the site are **Bewdley Medical Centre**, Dog Lane, Bewdley, DY12 2EG Tel – **01299 402157**.

Chemists – C G Murray & Son, 68 Load St, Bewdley, Tel – **01299 402132**.

Fish & Chip Shops – Sutton Road Fish & Chip Shop, Kidderminster (by the Hospital). Tel – 01562 745619

Catchem's End Fish Bar, Bewdley. Tel – 01299 403615

Shopping – Kidderminster boasts a wealth of supermarkets including – Co-op, Sainsburys, Tesco, Morrisons, Aldi & Netto – many of which provide ample free parking.

HOW TO FIND US

Rhydd Covert Camp Site is situated adjacent to West Midland Safari Park on the A456 between Kidderminster & Bewdley. **OS Map no 38, Grid Ref – SO 807 759**

Rhydd Covert Warden - Mr Chris Reynolds

“Grove End”, Olive Grove, Stourport. DY13 8XY.
07721 496803 warden@rhyddcovert.org.uk

Bookings Manager – Kathy Baylis.

11 Offmore Road, Kidderminster, Worcs. DY10 1SA
01562 754257 bookings@rhyddcovert.org.uk

Rhydd Covert Website – www.rhyddcovert.org.uk

Jan 2012 TB